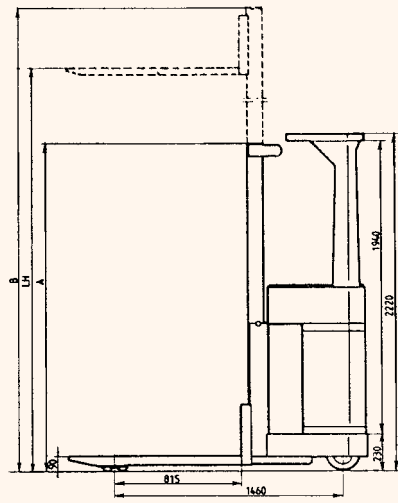
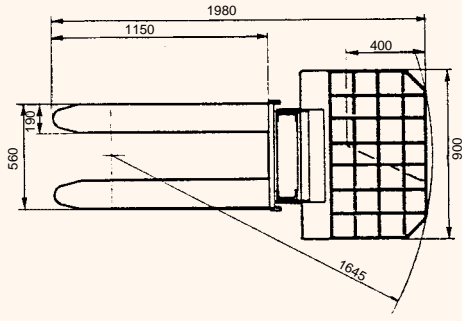

Table of measures SF - SFS 1250



Type of machine	LH mm	A mm	B mm	Capacity kg
SF 1250	3400	2220	3850	1250
SF 1250	5000	2220	5450	600
SFS 1250	5000	2220	5450	1250



Kentruck

KENTRUCK AB
 SE - 668 32 ED • Sweden
 Tel: +46 (0)534 625 00
 Fax +46 (0)534 625 10
 E-mail office@kentruck.se
 www.kentruck.se

NEW GENERATION

Kentruck

SF-SFS 1250

The new generationen
 powered ride on stackers

- Flexible
- Ergonomic
- Easy to manouvre

Technical specifications:

	SF	SF	SFS
Lifting capacity	1250 kg	1250 kg	1250 kg
Lifting capacity	3400 mm	5000 mm	5000 mm
Mast type	Duplex	Triplex	Triplex
Hydraulic supporting legs	-	-	Included
Lifting speed with / without load	0,20-0,35m/s	0,20-0,35m/s	0,20-0,35m/s
Lowering speed with/without load	0,50-0,20m/s	0,50-0,20m/s	0,50-0,20m/s
Driving speed with/without load	8,5-9,0 km/h	8,5-9,0 km/h	8,5-9,0 km/h
Aisle width	2300 mm	2300 mm	2300 mm
Electronic	ZAPI	ZAPI	ZAPI
Battery indicator / hour counter	ZAPI	ZAPI	ZAPI
Drive wheel indicator	ZAPI	ZAPI	ZAPI
Drive motor	24V/1600W	24V/1600W	24V/1600W
Hydraulic motor	24V/4000W	24V/4000W	24V/4000W
Battery	24V/246-465Ah/5h	24V/246-465Ah/5h	24V/246-465h/5h
Charger	24V/30-60A	24V/30-60A	24V/30-60A
Drive wheel	Polyurethane	Polyurethane	Polyurethane
Rollers supporting legs tandem	Polyurethane	Polyurethane	Polyurethane
Weight without battery	1075 kg	1175 kg	1200 kg

Kentruck retains the right to make changes in design and specifications without priore notice.

A selection from our wide range of products



Dealer



Kentruck AB

Introduces **SF-SFS 1250** range of flexible powered ride on stackers. The objective of this range of stackers is to offer the market place a stacker that can operate easily in confined areas with heavy usage.

Mast

SF-SFS 1250 has maximum visibility and high stability. Both **SF** and **SFS 1250** are equipped with full free lift as standard. This maximises the flexibility of the stacker in variety of working environments. The mast and fork carriage are fully adjustable to save wear and tear.

No efforts have been spared in creating a new design of hydraulics with superior lifting and lowering performance.

The **SF-SFS 1250** are available as standard with two lift heights. Duplex 3400 mm and triplex 5000 mm. The **SFS 1250** is available with triplex 5000 mm mast and also equipped with hydraulic supporting legs as standard. This construction makes it possible to lift up to 5000 lift height without reduction the capacity.

Ergonomic driving compartment

Considerable effort has been put into the design of the ergonomic and user friendly driving compartment. The **SF-SFS 1250** are the first ride on stackers to be equipped with an programmable electrical steering as standard. The truck is fitted with adjustable steering to ensure optimum efficiency and comfort for the operator.

The **SF-SFS 1250** is also fitted with an electric joystick as standard. All functions, speed control, lifting and lowering and electrical horn are fiotted neatly into the control handle.

Instrument

The **SF-SFS 1250** are fitted with a battery discharge indicator and a hour meter. To simplify servicing and repairs there is a built in programmer that indicates any fault with a code on the display. To increase safety especially during the starting phase the SF-SFS 1250 is fitted with a control diode that shows the position of the steering wheel.

Elektronics

SF-SFS 1250 has ZAPI electronics fitted as standard wich control both the hydraulic and drive systems. All the drive and lifting parameters are adjustable to suit the preference of the operator.



SF-SFS 1250

- Battery indicator
- Working hour indicator
- Drive wheel indicator
- Lockable main switch



SF-SFS 1250

- Flexibility
- High speed
- Free-lift mast
- Free-sight mast
- Lifting height 3400 mm
- Lifting height 5000 mm
- Lifting capacity 1250 kg
- Proportional controlled hydraulic
- Speed controlled hydraulic motor



SF-SFS 1250

- All electronic on one place
- Programmable electronic on the:
 - steering functions
 - speed control
 - brake control
 - hydraulic control



SF-SFS 1250

- Electrical steering
- Adjustable position of the driving wheel
- Joystick controls:
 - lifting function
 - lowering function
 - speed regulation
 - driving forward
 - driving backwards
 - horn



Made in Sweden

